

# ERT KERRISON RONGEUR SYSTEM

## ERT KERRISON RONGEUR SYSTEM

360° DREHBAR  
360° ROTATION



ERT = EIGHTFOLD - ROTATING - TAKE-APART  
RONGEUR SYSTEM

**ERT Kerrison 360° drehbares Rongeur System**  
**ERT Kerrison 360° rotating Rongeur System****Advantage:**

- Arm of Surgeon can always remain in the same position
- No need for upbiting, downbiting or side-nibbling Kerrisons any more
- Suitable for all kinds of shafts:
  - straight
  - Bayonet
  - Curved Up
- No need to keep a large stock of different Kerrissons

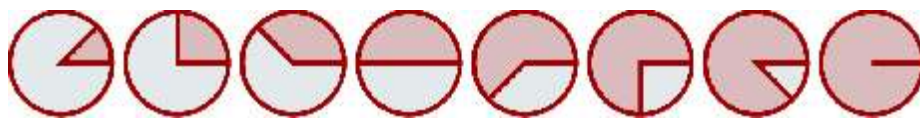

Choose from 8 different angles while your hand remains in the same position

**0°****45°****90°****135°****180°****225°****270°****315°**

## ERT Kerrison 360° drehbares Rongeur System ERT Kerrison 360° rotating Rongeur System

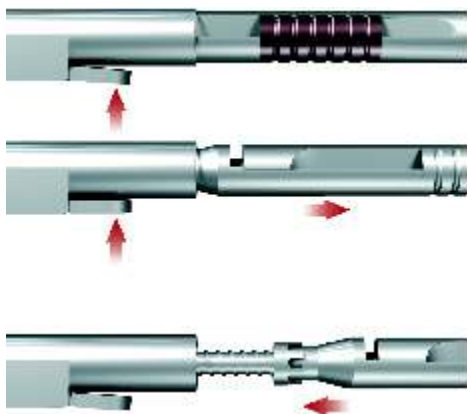
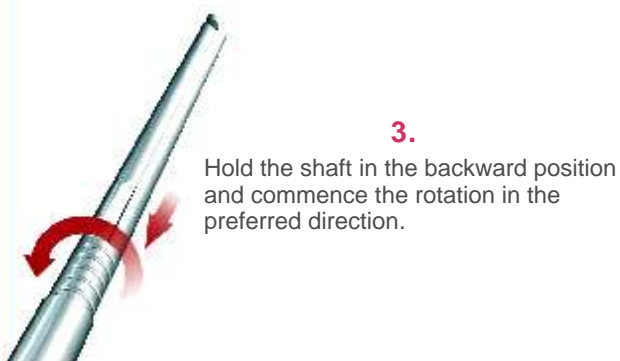
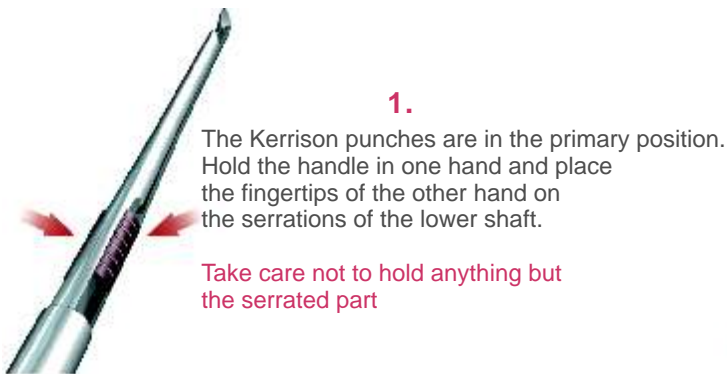

**1.**  
Simultaneously with pressing the button pull the shaft forward to detach it from the handle.

**2.**  
To reconnect your ERT Kerrison simply slide the shaft in the opposite direction upon hearing the clicking sound the instrument is once again ready

**ERT Kerrison 360° drehbares Rongeur System**  
**ERT Kerrison 360° rotating Rongeur System****1.**

Once the shaft is pulled out you can easily recognize the 4 parts on it that must be dismantled for sterilization

**2.**

The shaft is secured by the spring system. After it is unscrewed you can easily disunite the lower and upper shaft.

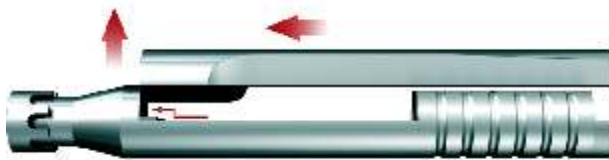
**3.**

The shafts can not be separated while the upper shaft is in forward position. Slide back the upper shaft towards the edge on the lower shaft and pull it upwards. Then you can lift the upper shaft out of the T-groove.

**4.**

When the sterilization process is completed the parts are easily reassembled according to the previous instruction

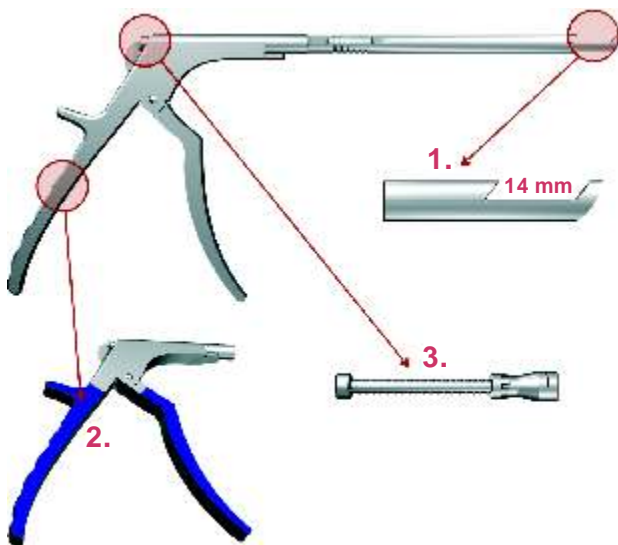
**1.**

Small handle, but at the same time 14mm mouth opening. Perfect for surgeons, who do not like the large Kerrison handles, but do not want to miss the advantages of a large mouth opening.

**2.**

The advanced spring system rules out any problems with springs slipping off or breaking as well as gloves getting caught in the spring. Surgeons are also enable a better view on the operating field during surgery.

**3.**

To ensure even better performance new FILLIGREE-Handle Technology is also available providing a better and softer grip.

## ERT Kerrison 360° drehbares Rongeur System ERT Kerrison 360° rotating Rongeur System



**ERT Shaft**

**ERT Shaft rotating 360° complete 40°**

Art.-No.	Shaft - lenght	width of bit
41.013.01	18 cm	1 mm
41.013.02	18 cm	2 mm
41.013.03	18 cm	3 mm
41.013.04	18 cm	4 mm
41.013.05	18 cm	5 mm
41.013.06	18 cm	6 mm
41.015.01	20 cm	1 mm
41.015.02	20 cm	2 mm
41.015.03	20 cm	3 mm
41.015.04	20 cm	4 mm
41.015.05	20 cm	5 mm
41.015.06	20 cm	6 mm
41.017.01	23 cm	1 mm
41.017.02	23 cm	2 mm
41.017.03	23 cm	3 mm
41.017.04	23 cm	4 mm
41.017.05	23 cm	5 mm
41.017.06	23 cm	6 mm
41.019.01	25 cm	1 mm
41.019.02	25 cm	2 mm
41.019.03	25 cm	3 mm
41.019.04	25 cm	4 mm
41.019.05	25 cm	5 mm
41.019.06	25 cm	6 mm

**ERT Shaft rotating 360° complete 90°**

Art.-No.	Shaft - lenght	width of bit
41.012.01	18 cm	1 mm
41.012.02	18 cm	2 mm
41.012.03	18 cm	3 mm
41.012.04	18 cm	4 mm
41.012.05	18 cm	5 mm
41.012.06	18 cm	6 mm
41.014.01	20 cm	1 mm
41.014.02	20 cm	2 mm
41.014.03	20 cm	3 mm
41.014.04	20 cm	4 mm
41.014.05	20 cm	5 mm
41.014.06	20 cm	6 mm
41.016.01	23 cm	1 mm
41.016.02	23 cm	2 mm
41.016.03	23 cm	3 mm
41.016.04	23 cm	4 mm
41.016.05	23 cm	5 mm
41.016.06	23 cm	6 mm



**ERT Shaft  
with tin food**

**ERT Shaft rotating 360° complete 40°  
thin food**

Art.-No.	Shaft - lenght	width of bit
41.033.01	18 cm	1 mm
41.033.02	18 cm	2 mm
41.033.03	18 cm	3 mm
41.033.04	18 cm	4 mm
41.033.05	18 cm	5 mm
41.033.06	18 cm	6 mm
41.035.01	20 cm	1 mm
41.035.02	20 cm	2 mm
41.035.03	20 cm	3 mm
41.035.04	20 cm	4 mm
41.035.05	20 cm	5 mm
41.035.06	20 cm	6 mm
41.037.01	23 cm	1 mm
41.037.02	23 cm	2 mm
41.037.03	23 cm	3 mm
41.037.04	23 cm	4 mm
41.037.05	23 cm	5 mm
41.037.06	23 cm	6 mm
41.039.01	25 cm	1 mm
41.039.02	25 cm	2 mm
41.039.03	25 cm	3 mm
41.039.04	25 cm	4 mm
41.039.05	25 cm	5 mm
41.039.06	25 cm	6 mm

**ERT Shaft rotating 360° complete 90°  
thin food**

Art.-No.	Shaft - lenght	width of bit
41.032.01	18 cm	1 mm
41.032.02	18 cm	2 mm
41.032.03	18 cm	3 mm
41.032.04	18 cm	4 mm
41.032.05	18 cm	5 mm
41.032.06	18 cm	6 mm
41.034.01	20 cm	1 mm
41.034.02	20 cm	2 mm
41.034.03	20 cm	3 mm
41.034.04	20 cm	4 mm
41.034.05	20 cm	5 mm
41.034.06	20 cm	6 mm
41.036.01	23 cm	1 mm
41.036.02	23 cm	2 mm
41.036.03	23 cm	3 mm
41.036.04	23 cm	4 mm
41.036.05	23 cm	5 mm
41.036.06	23 cm	6 mm

## ERT Kerrison 360° drehbares Rongeur System ERT Kerrison 360° rotating Rongeur System



**ERT Shaft with TOP throw off**

**ERT Shaft rotating 360° complete 40°  
with TOP throw off**

Art.-No.	Shaft - lenght	width of bit
41.013.01TP	18 cm	1 mm
41.013.02TP	18 cm	2 mm
41.013.03TP	18 cm	3 mm
41.013.04TP	18 cm	4 mm
41.013.05TP	18 cm	5 mm
41.013.06TP	18 cm	6 mm
41.015.01TP	20 cm	1 mm
41.015.02TP	20 cm	2 mm
41.015.03TP	20 cm	3 mm
41.015.04TP	20 cm	4 mm
41.015.05TP	20 cm	5 mm
41.015.06TP	20 cm	6 mm
41.017.01TP	23 cm	1 mm
41.017.02TP	23 cm	2 mm
41.017.03TP	23 cm	3 mm
41.017.04TP	23 cm	4 mm
41.017.05TP	23 cm	5 mm
41.017.06TP	23 cm	6 mm
41.019.01TP	25 cm	1 mm
41.019.02TP	25 cm	2 mm
41.019.03TP	25 cm	3 mm
41.019.04TP	25 cm	4 mm
41.019.05TP	25 cm	5 mm
41.019.06TP	25 cm	6 mm

**ERT Shaft rotating 360° complete 90°  
with TOP throw off**

Art.-No.	Shaft - lenght	width of bit
41.012.01TP	18 cm	1 mm
41.012.02TP	18 cm	2 mm
41.012.03TP	18 cm	3 mm
41.012.04TP	18 cm	4 mm
41.012.05TP	18 cm	5 mm
41.012.06TP	18 cm	6 mm
41.014.01TP	20 cm	1 mm
41.014.02TP	20 cm	2 mm
41.014.03TP	20 cm	3 mm
41.014.04TP	20 cm	4 mm
41.014.05TP	20 cm	5 mm
41.014.06TP	20 cm	6 mm
41.016.01TP	23 cm	1 mm
41.016.02TP	23 cm	2 mm
41.016.03TP	23 cm	3 mm
41.016.04TP	23 cm	4 mm
41.016.05TP	23 cm	5 mm
41.016.06TP	23 cm	6 mm



**ERT Shaft with TOP throw off  
and thin food**

**ERT Shaft rotating 360° complete 40°  
with TOP throw off and thin food**

Art.-No.	Shaft - lenght	width of bit
41.033.01TP	18 cm	1 mm
41.033.02TP	18 cm	2 mm
41.033.03TP	18 cm	3 mm
41.033.04TP	18 cm	4 mm
41.033.05TP	18 cm	5 mm
41.033.06TP	18 cm	6 mm
41.035.01TP	20 cm	1 mm
41.035.02TP	20 cm	2 mm
41.035.03TP	20 cm	3 mm
41.035.04TP	20 cm	4 mm
41.035.05TP	20 cm	5 mm
41.035.06TP	20 cm	6 mm
41.037.01TP	23 cm	1 mm
41.037.02TP	23 cm	2 mm
41.037.03TP	23 cm	3 mm
41.037.04TP	23 cm	4 mm
41.037.05TP	23 cm	5 mm
41.037.06TP	23 cm	6 mm
41.039.01TP	25 cm	1 mm
41.039.02TP	25 cm	2 mm
41.039.03TP	25 cm	3 mm
41.039.04TP	25 cm	4 mm
41.039.05TP	25 cm	5 mm
41.039.06TP	25 cm	6 mm

**ERT Shaft rotating 360° complete 90°  
with TOP throw off and thin food**

Art.-No.	Shaft - lenght	width of bit
41.032.01TP	18 cm	1 mm
41.032.02TP	18 cm	2 mm
41.032.03TP	18 cm	3 mm
41.032.04TP	18 cm	4 mm
41.032.05TP	18 cm	5 mm
41.032.06TP	18 cm	6 mm
41.034.01TP	20 cm	1 mm
41.034.02TP	20 cm	2 mm
41.034.03TP	20 cm	3 mm
41.034.04TP	20 cm	4 mm
41.034.05TP	20 cm	5 mm
41.034.06TP	20 cm	6 mm
41.036.01TP	23 cm	1 mm
41.036.02TP	23 cm	2 mm
41.036.03TP	23 cm	3 mm
41.036.04TP	23 cm	4 mm
41.036.05TP	23 cm	5 mm
41.036.06TP	23 cm	6 mm

## ERT Kerrison 360° drehbares Rongeur System ERT Kerrison 360° rotating Rongeur System



**ERT Shaft bayonet**

**ERT Shaft bayonet rotating 360° complete 40°**

Art.-No.	Shaft - lenght	width of bit
41.051.03	15 cm	3 mm
41.051.04	15 cm	4 mm
41.053.01	18 cm	1 mm
41.053.02	18 cm	2 mm
41.053.03	18 cm	3 mm
41.053.04	18 cm	4 mm
41.053.05	18 cm	5 mm
41.053.06	18 cm	6 mm
41.055.03	20 cm	3 mm
41.055.04	20 cm	4 mm

**ERT Shaft bayonet rotating 360° complete 40°  
with TOP throw out**

Art.-No.	Shaft - lenght	width of bit
41.051.03TP	15 cm	3 mm
41.051.04TP	15 cm	4 mm
41.053.01TP	18 cm	1 mm
41.053.02TP	18 cm	2 mm
41.053.03TP	18 cm	3 mm
41.053.04TP	18 cm	4 mm
41.053.05TP	18 cm	5 mm
41.053.06TP	18 cm	6 mm
41.055.03TP	20 cm	3 mm
41.055.04TP	20 cm	4 mm



**ERT Shaft bayonet  
thin food**

**ERT Shaft bayonet rotating 360° complete 40°  
thin food**

Art.-No.	Shaft - lenght	width of bit
41.063.02	18 cm	2 mm
41.063.03	18 cm	3 mm
41.063.04	18 cm	4 mm

**ERT Shaft bayonet rotating 360° complete 40°  
with TOP throw off and thin food**

Art.-No.	Shaft - lenght	width of bit
41.063.02TP	18 cm	2 mm
41.063.03TP	18 cm	3 mm
41.063.04TP	18 cm	4 mm



**ERT Shaft curved up rotating 360° complete 40°**

Art.-No.	Shaft - lenght	width of bit
41.079.02	20 cm	2 mm
41.079.03	20 cm	3 mm
41.079.04	20 cm	4 mm



**Handle for  
ERT Rongeur  
41.000.01**

**ANTON HIPPI GMBH MEDICAL**

Instrumente und Implantate

Annastrasse 25/1  
D-78567 Fridingen  
Germany

Postfach 80  
D-78565 Fridingen  
Germany

Tel: +49-(0)7463-99303-0  
Fax: +49-(0)7463-99303-50

Mail: [info@anton-hipp.de](mailto:info@anton-hipp.de)  
[www.anton-hipp.de](http://www.anton-hipp.de)